

New	Replaces Old	Why?
JQB0373A THE JQRacing Low RC Front Shock Tower (WE)	JQB0313	Higher shock and link holes for improved handling.
JQB0374A THE JQRacing Low RC Rear Shock Tower (WE)	JQB0314	Higher shock and link holes for improved handling.
JQB0375 THE JQRacing C Hub 15 Deg Left, High Link (WE)	JQB0351	15 deg caster, higher link holes, only one arm location.
JQB0376 THE JQRacing C Hub 15 Deg Right, High Link (WE)	JQB0352	15 deg caster, higher link holes, only one arm location.
JQB0378 THE JQRacing Rear Hub Left, High Link (WE)	JQB0325	Higher link holes and less of them.
JQB0379 THE JQRacing Rear Hub Right, High Link (WE)	JQB0326	Higher link holes and less of them.
JQB0380 THE JQRacing 2 Piece Steering Knuckle Left (WE)	JQB0321	Separate steering arm for adjusting ackermann.
JQB0381 THE JQRacing 2 Piece Steering Knuckle Right (WE)	JQB0322	Separate steering arm for adjusting ackermann.
JQB0382 THE JQRacing 2 Piece St Knuckle Arm #1 (WE)	N/A	Separate steering arm for adjusting ackermann.
JQB0383 THE JQRacing Plastic Bearing Insert 4pcs (WE)	N/A	New hubs use bearing inserts for improved fit.
JQB0384 THE JQRacing 7x1.2 Flat Piston	JQB0327	New stock pistons for better handling.
JQB0385 THE JQRacing 7x1.3 Flat Piston	JQB0328	New stock pistons for better handling.
JQB0386 THE JQRacing R-F "C" Plate +2 High (WE)	JQB0309	High R-F plate for better handling.
JQB0387 THE JQRacing R-R "D" Plate +2 High 3 Deg (WE)	JQB0308	High toe plate for better handling with simple insert.
JQB0388 THE JQRacing R-R "D" Plate +2 High 2.5 Deg (WE)	JQB0308	High toe plate for better handling with simple insert.
JQB0389 THE JQRacing R-R "D" Plate +2 High 2 Deg (WE)	JQB0308	High toe plate for better handling with simple insert.
JQB0372 THE JQRacing Driveshaft Pair L 90.5mm WE Front	JQB0163	Longer driveshafts a standard for the front only.

New and Popular Option Parts

JQB0370	THE JQRacing Hard Front Arms (WE)
JQB0371	THE JQRacing Hard Rear Arms (WE)
JQB0390	THE JQRacing Easy Adjustment Brake Linkage
JQB0391	THE JQRacing 48t Maingear (WE)
JQB0349	THE JQRacing CNC High Wingmount R (Gold)
JQB0350	THE JQRacing CNC High Wingmount L (Gold)
JQB0287	THE JQRacing CNC Servo Saver Top (Gold)
JQB0197	THE JQRacing CNC High Wingmount R (Black)
JQB0198	THE JQRacing CNC High Wingmount L (Black)
JQB0175	THE JQRacing CNC Servo Saver Top (Black)
JQB0295	THE JQRacing CNC Th Servo Arm Savox 25X (WE)
JQB0194	THE JQRacing Lightweight +1mm Hex & Nuts (2pcs)

Use 2 Shims Behind Each Big Gear In All Diffs

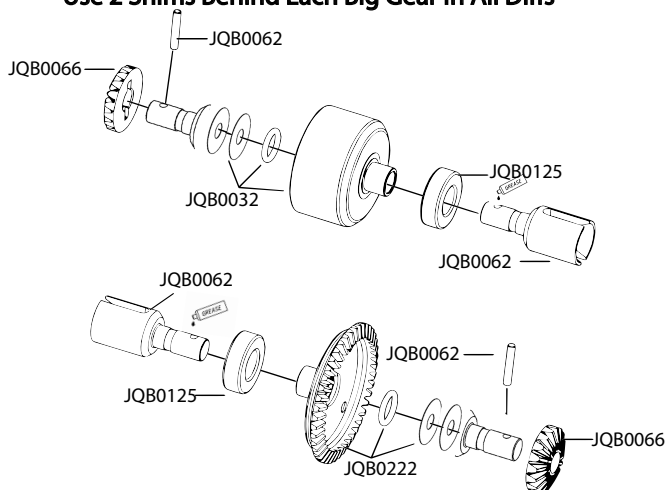

FRONT

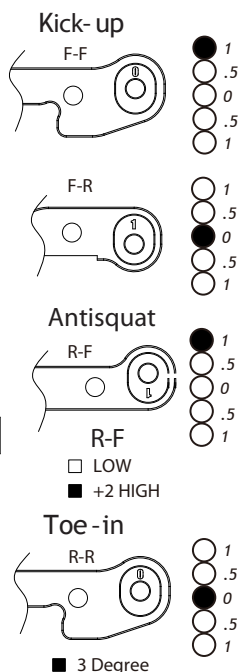
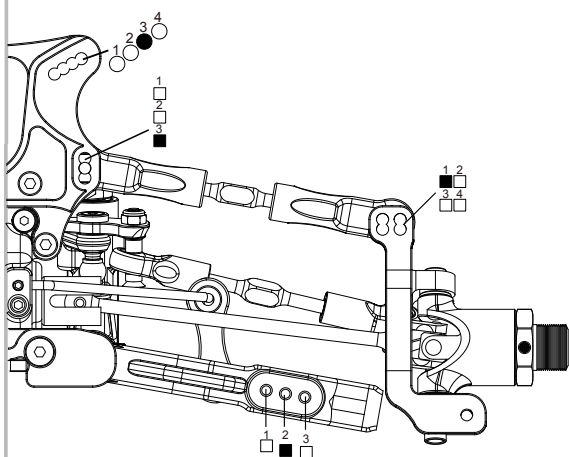

REAR

